UNLOCKING THE POTENTIAL FOR 50 YEARS



Architectural
PANEL SOLUTIONS

50 YEARS Petrarch

DOWNER®
ORIGINAL HELPING HAND SYSTEM

CELEBRATING 50 YEARS AS THE NATURAL CHOICE

This year marks an exciting new era for Petrarch, as our engineered stone rainscreen turns 50. Since 1972 our unique panel has been transforming the face of living and working spaces. Today we're proud to say that Petrarch adorns buildings across the UK, Europe and the USA thanks to a robust and respected distribution network.

We're so proud to mark the 50th year of Petrarch with this exclusive Lookbook, featuring award-winning projects from around the world.

1972 - 2022



Filmworks

Architect: www.tpbennett.com/projects/filmworks-ealing/

Developer/Client:
www.berkeleygroup.co.uk/developments/london/ealing/filmworks-ealing

Installers:
www.richardson-roofing.com

Barretts of Aspley:
Balcony installers - Barretts of Aspley - Structural Steelwork, Architectural Metalwork and Balconies boa.uk.com

The Goldsmith Group:
Attentive restoration of the natural stone and installation of select areas of Petrarch:
www.thegoldsmithgroup.co.uk

St George, photographer Simon Winson

ENGINEERED TO PERFORM

Petrarch is an engineered stone rainscreen, carefully designed to be extremely weather resistant and withstand the most severe environmental conditions, and just like natural stone, it matures over time, giving character and depth to any architectural scheme.

An aesthetically striking panel with incredible strength, boasting an A2-s1,d0 reaction to fire rating (EN 13501). Highly durable and impact resistant, Petrarch is considerably lighter than natural stone systems.

Read more



Technology Innovation Centre

Colour: #1102B (Special)

Finish: Smooth Matt

Location: Glasgow, Scotland

Architect: BDP - Glasgow

Main Contractor: Lend Lease

1970's

THE INITIAL PROCESS AND PRODUCT TECHNOLOGY

was founded by Redland Technology in Sussex

1



72

PETRARCH'S SECRETS ARE SOUGHT AFTER



1996

Natural History Museum, London

Petrarch Graphite Riven. Customised Petrarch is chosen to create a captivating backdrop for museum visitors!

2020

BBA, CWCT, MIB IT'S A YEAR OF BIG THINGS FOR PETRARCH

Petrarch excels in CWCT Testing
Petrarch becomes Made In Britain members
Petrarch achieves BBA certification once again



2021

PETRARCH MAKES IT'S MARK IN...

The US with Omnis Panels, in The Netherlands with distributor CFS Nederland, in Ireland with Elemental and in Italy with Kalikos...



Petrarch wins... Best Refurbishment project at The Facade Awards



2022

1972 1973 1974 1975 1976 1977 1978 1979 1980 1981 1982 1983 1984 1985 1986 1987 1988 1989 1990 1991 1992 1993 1994 1995 1996 1997 1998 1999 2000 2001 2002 2003 2004 2005 2006 2007 2008 2009 2010 2011 2012 2013 2014 2015 2016 2017 2018 2019 2020 2021 2022

1972

PETRARCH PANELS

Redland Claddings sell Petrarch's secret formula and the company becomes Petrarch Claddings

RANGE IS DEVELOPED

Featuring over 1500 shades and 4 distinctive textures



1977

PETRARCH GOES STATESIDE

THE HOSPITAL AND MEDICAL SECTORS

Prove a real hit for Petrarch engineered stone rainscreen

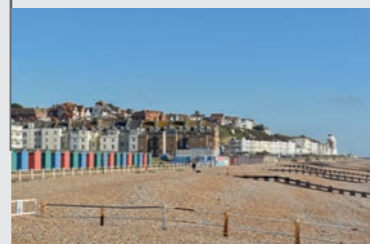

1986

Production moves from Bexhill to the Leonards On Sea factory

1990's

Behind the scenes the factory expands

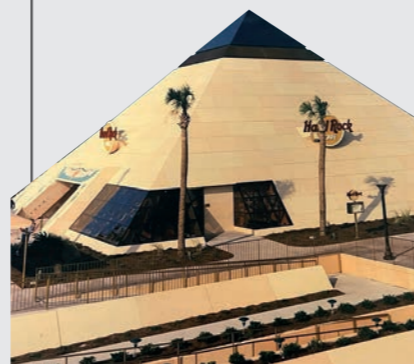
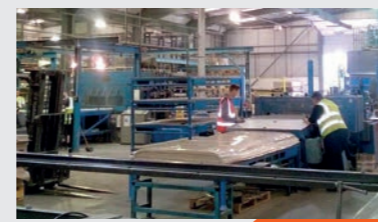

1995

Hard Rock Cafe Petrarch Pyramid

Technical secrets as sought after as the ancient Egyptians

RESIDENTIAL, EDUCATION, TRANSPORT, COMMERCIAL

There isn't a sector our Petrarch isn't popular in!



2018

APS ACQUIRE THE PETRARCH BRAND

and sets out on a mission to be the natural choice, helping specifiers unlock the potential globally

2000's

Award-winning projects worldwide!

2022

LOOKBOOK IS LAUNCHED

and Directors Pete Brough and Vince Lunn get ready for the next important steps in Petrarch's history

2022

APS LAUNCHES PETRARCH PLANX

A slimline, modern panel which optimised main panel production.

5

UNLOCKING THE POTENTIAL FOR 50 YEARS



Chobham Farm

Colour: Alabaster

Finish: Smooth Matt

Location: Stratford, London, UK

Architect: Pollard Thomas Edwards

Main Contractor: Telford Homes

Installer: Phase 1 - OCL Facades / Phase 2 - Gypcraft

WHY PETRARCH?

/ˈpetrɑ:k/

The origin of Petrarch in the first instance came from:

PETROS

THE ORIGINAL Greek version of the name 'Peter' meaning 'STONE' or 'ROCK'.

ARCHITECTURE

The art or practice of designing and constructing buildings.

THUS CREATING 'PETRARCH' WHICH REFLECTS THE QUALITIES OF BOTH 'STONE' AND 'ARCHITECTURE'

Incidentally, yet quite remarkably, it is also the name of world-renowned poet Francesco Petrarca, 1304-74, Italian poet and scholar. Petrarch's sonnets were imitated and admired across Europe and they also became a prototype for lyrical poetry. 'Petrarch was truly an original, to whom no-one could be compared! Elegance. Versatility. Diversity. Originality.

These are the cornerstones which have shaped our brand which today is the natural choice for specifiers and designers around the world. Changing the face of living and working spaces worldwide for half a century.



AN ORIGINAL
NEVER RESTS
ON ITS LAURELS,
YET EVOLVES
AND INNOVATES

Royal Wharf

Colour: Petrarch Engineered
Stone #1158B (Special)

Finish: Smooth Matt

Location: Silvertown, London, UK

Architect: WCEC Architects

Main Contractor: Ballymore

Subcontractor: Prater

WHAT A LEGACY...

And as with every legacy, there are legends.

Everyone seems to have their favourite.

Here are just a few of our favourite Petrarch Legends.

HARD ROCK CAFE'S PETRARCH PYRAMID

Eternally enchanting. There's something timelessly magical and intriguing about pyramids. Sadly this Petrarch pyramid, designed by Zakaspace, no longer exists today, however at the time it was an absolute show-stopper and a great reference for our engineered stone panels.



The Hard Rock Pyramid

Location: Broadway at The Beach,
The Grand Strand, Myrtle Beach, SC

Function: Night Club

Owner: Hard Rock Cafe, International

Size: 70' tall, 19,000 sq ft, 52 degrees

Architects: Architect Division of Zakaspace

Opened: July, 1995

Occupants: 250 Rockers

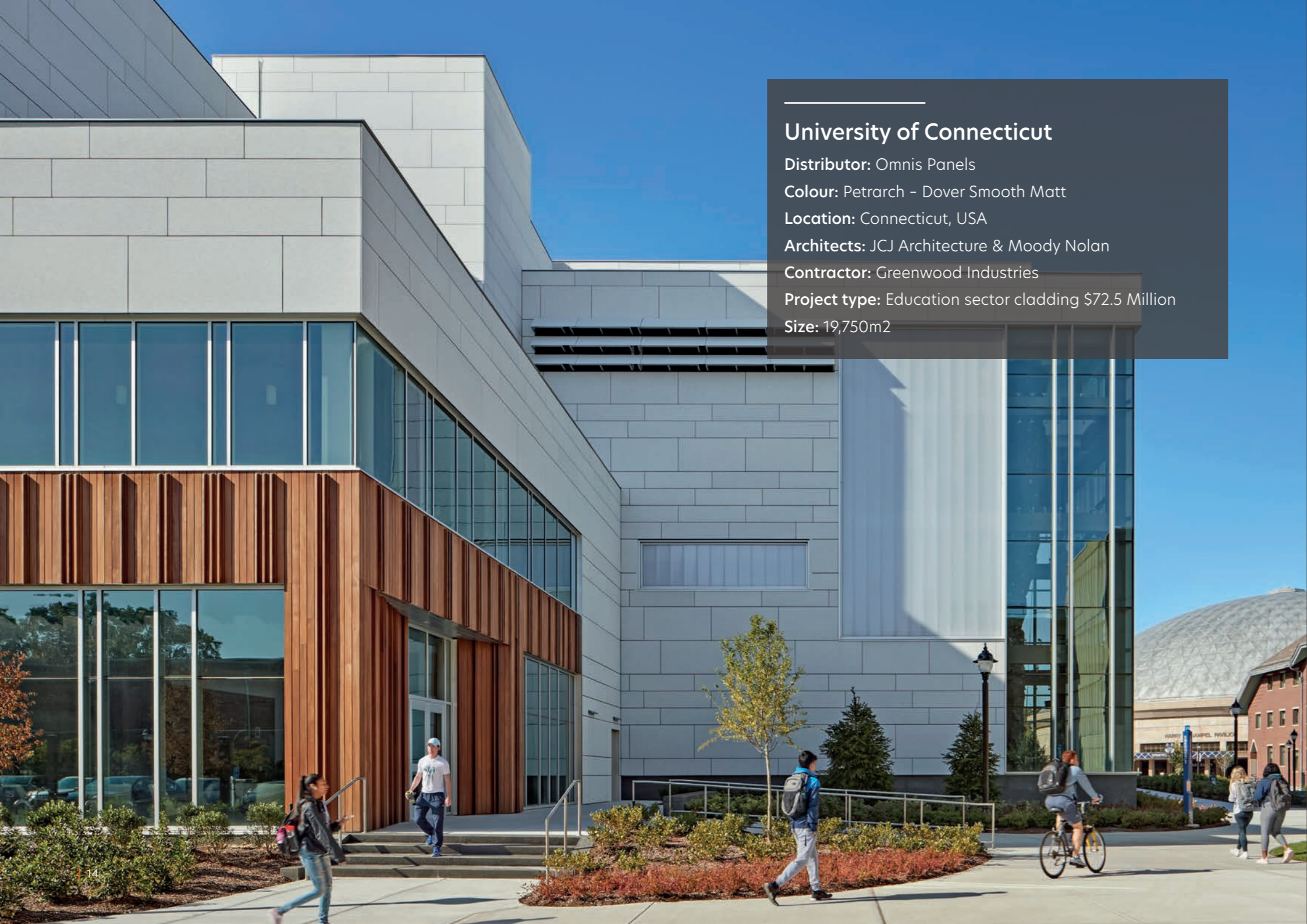

University of Connecticut

Distributor: Omnis Panels
Colour: Petrarch – Dover Smooth Matt
Location: Connecticut, USA
Architects: JCJ Architecture & Moody Nolan
Contractor: Greenwood Industries
Project type: Education sector cladding \$72.5 Million
Size: 19,750m2

AWARD-WINNING UCONN

'The University of Connecticut (UCONN) is a top-ranked public research institution with campuses across Connecticut. Its mission is to embrace diversity and cultivate leadership, integrity, and engaged citizenship in students, faculty, staff, and alumni.

In order to bring this vision to life and to channel the spirit of 'innovation' UCONN turned to JCJ Architecture and Moody Nolan to design its new Student Recreation Centre!

Education sector cladding – the selection process

Education sector projects often pose a challenge when it comes to façade selection, with a stringent 'must-have' tick-list and usually tight budgets to adhere to. The University of Connecticut's Recreation Centre was no exception. Petrarch's appealing reconstituted stone aesthetic, intrinsic fire-resistant qualities (A2, s1-d0 according to EN 13501-1), durability and its easy installation, were just some of the reasons why it was chosen.

The Student Recreation Centre has been recognised as an Outstanding Facility of Merit in the 2021 NIRSA Awards.

[Read more](#)



PETRARCH INTRIGUES AND CAPTIVATES AT NATURAL HISTORY MUSEUM

Looking as spectacular now, as when it was first installed in 1996, our Petrarch engineered stone panelling wows visitors to this day at the Natural History Museum.

Designed to intrigue and captivate, graphite Petrarch panels have been designed specifically for the Natural History Museum to tell its marvellous story. Bringing the world of space to life in dramatic form.

Realised by architects 'Pawson Williams Architects', the project saw an attentive remodelling and restoration of the original 1930's building.

Acting as a theatrical and textural blank canvas, Petrarch in riven Graphite serves as a backdrop to fascinating constellations and Natural History facts. 'The celestial map adorning the walls of Earth Hall provides a beautiful backdrop to the Museum's giant metal Earth sculpture.'

'It's still a fascinating and nostalgic experience for me to visit the National History Museum. I remember being a 6 year old boy and running my hands along those walls and appreciating the constellations. Little did I know that one day I would be selling that very material. How many small hands (and all that small hands entail) have ran across those same walls - a sure test of the durability and resistance of our engineered stone cladding. (I'm now 31 and still feel compelled to do the same.) Tom Walker, Sales Director

Read more



Natural History Museum, London

Material: Petrarch Graphite Riven

Architect: Pawson Williams Architects,
London, 1996 Realised: 1996

Sector: Arts and culture



Deltion College

Location: Zwolle, 2017

Material: Petrarch cladding

Distributor: CFS Nederland

Color: 003 Graphite

Surface: Riven Matt

Architect: ARES architects

DELTION COLLEGE

A fantastic education sector project brought to us by Petrarch distributors CFS Nederland and ARES Architects. As a centre of excellence for the country's MBO Defence students, naturally its design is striking.

Its sleek, modern aesthetic, featuring contemporary Petrarch Panel accents, boasts hidden secrets... You can't see it, but up on the roof, there's an impressive concealed sports training ground. Thanks to its durable, weather resistant properties and versatility, Petrarch cladding was chosen for high impact areas such as the ground floor and on the roof, as door coverings!

Read more



THE FILMWORKS WINS BEST REFURBISHMENT PROJECT

Capturing all the glamour and splendour of the roaring twenties this latest scheme takes to the spotlight. For the restoration of this magnificent building, St. George and TP Bennett turned to a rainscreen which would not only project the right image, yet stand up to the most demanding requirements.

For a building with such status and heritage, both St. George and TP Bennett opted for a rainscreen solution which would not only project exactly the right image, yet stand up to the most demanding requirements. As a mixed-use development, comprising 209 new homes overlooking a central square, lined with bars and restaurants, and an impressive double-height entrance foyer to the eight-screen Picturehouse Cinema, 'the biggest outside London's West End,' it was vital that the chosen rainscreen could withstand numerous vying challenges. Thanks to a comprehensive list of intrinsic qualities; including extreme weather resistance, durability, longevity, impact and graffiti resistance, as well as BBA, CWCT and NHBC 2021 certification, Petrarch ticked all the right boxes and exudes pure elegance with its smooth Alabaster finish.

Read more about
the award win

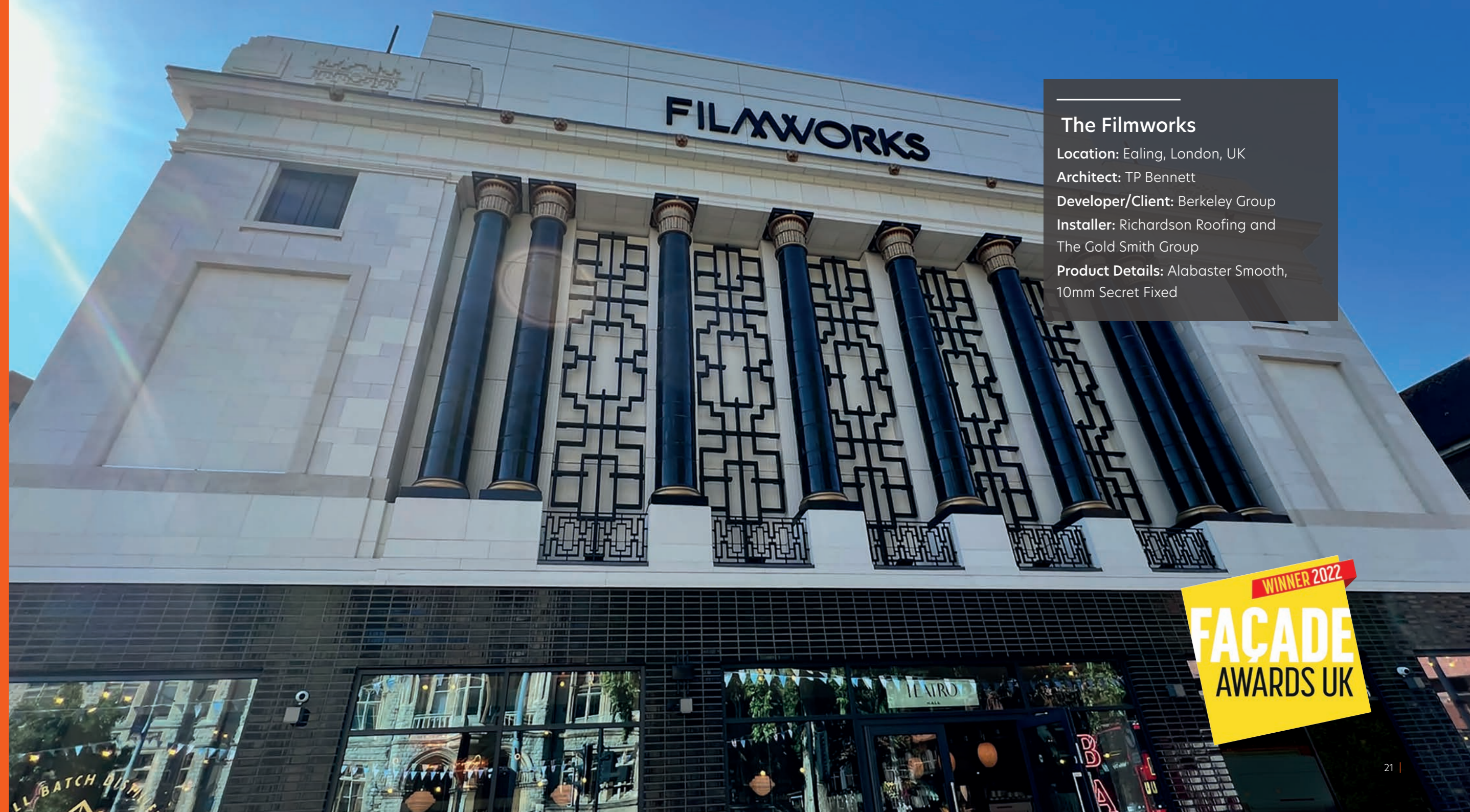

The Filmworks

Location: Ealing, London, UK

Architect: TP Bennett

Developer/Client: Berkeley Group

Installer: Richardson Roofing and
The Gold Smith Group

Product Details: Alabaster Smooth,
10mm Secret Fixed





University of Massachusetts (UMASS)

Location: 360 Campus Center Way, Amherst MA

Architect: Perkins+Will / HOK

General Contractor: Consigli Construction Co., Inc.

Colour: Limestone Smooth

UNIVERSITY OF MASSACHUSETTS (UMASS)

When UMass became a full member of the NCAA Division I Football Bowl Subdivision (FBS), the university retained HOK and Perkins+Will to design a new football training facility and undertake upgrades to McGuirk Alumni Stadium.

Positioned to infill the stadium at its north end zone, the Football Performance Centre consolidates program areas previously scattered across campus. In addition to supporting the daily needs of student athletes, it serves as a recruiting tool for coaches to use to attract the best talent and build a nationally competitive programme.

Read more



POLICE STATION BERGEN OP ZOOM

There aren't many police stations such as this one, more's the pity. Inspired by the natural tones of the Dutch countryside, this striking public sector project is a stunning showcase for Petrarch. If you've been wondering just what can be achieved with our extensive colour palette, this station helps show you.

An expanse of Petrarch adorns Bergen Op Zoom which comprises approximately of 8,500 m² of Petrarch.

'The entire concept is inspired by typical Dutch landscapes: forest, water, dunes, beach, sea, sky, fields, views, etc. To achieve this, three natural tones were utilised.'

Scoring high on the sustainability gauge too, this contemporary station is designed to be almost energy neutral (BENG), boasting all of this: 'green' roof with solar panels, LED lighting, a thermal storage system and a system for the delayed drainage of rainwater on its own site.

'This is certainly one of our favourite Petrarch projects. Bergen Op Zoom is one of those projects we refer to often when clients want to see the diversity of Petrarch's colour palette. Working with innovative partners and talented architects allow us to add such great references to our portfolio.' Tom Walker, Sales Director.

Winner Residential RICS Awards 2017 London

Offsite awards 2016 - Best Use of Volumetric Technology

Read more



POLICE STATION BERGEN OP ZOOM

Project: Bergen Op Zoom, Police Station

Colour: Custom colours

Architect: Van Pelten Architects

References: www.vpaa.nl/oplevering-nieuwe-politiekantoor-met-gemeenschappelijke-meldkamer-bergen-op-zoom/
www.cfsnederland.nl/project/politiebureau-bergen-op-zoom/

OYSTER RIVER MIDDLE SCHOOL

We're proud of just how many of our Petrarch projects boast exemplary sustainability features. Oyster Middle School, New Hampshire, is one such example.

The new Oyster River Middle School is the largest energy-self-sustaining school in the state; designed to meet Net-Positive Energy criteria with on-site renewable energy technologies: a 70-borehole geothermal heating/cooling system; and photovoltaic arrays to produce electricity and hot water.

The building is currently on track to generate 120% more energy than it uses and the school expects to see massive estimated energy savings of \$2 million over 20 years. Leaders anticipate the building will achieve LEED Gold-certification thanks to its sustainable design.

Petrarch engineered stone panels were the preferred choice due to their high durability, intrinsic strength, lifespan, sustainable properties and designability.

[Read more](#)



Oyster River Middle School

Architect: Lavellee Brensinger Architects

General Contractor: Bauen Corporation

Installer: Exterior Designs

Petrarch Representative:

Omnis/ Shannon Corporation

Solar Power: ReVision Energy



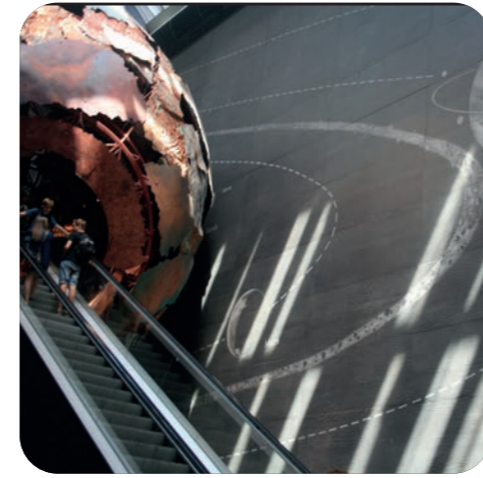



info@petrarchpanels.com | www.petrarchpanels.com



Please do not share this content without confirming before-hand due to stringent photography rights. Correct at the time of going to press (November 2022). APS reserves the right to withdraw or make alterations if necessary. Please visit www.petrarchpanels.com for more info.